



## Manual lubrication tools

- Lever grease gun
- Drum pumps
- Grease pistols
- Transport aids



# Manual lubrication tools

## Lever grease gun ..... 118

The lever grease gun is suitable for high lubrication pressures. The proven TWIN-LOCK system protects the lever grease gun against abrasion during continuous operation and prevents the risk of quasi-lubrication to machines and equipment.

---

## Drum pumps ..... 122

Manual and pneumatic drum pumps are suitable for delivering large quantities of grease under high pressure over long distances. However, they can also be used to fill the CONCEPT lubricators and associated cartridges.

When directly inserted in the original container, they facilitate economical use (less time required and optimal emptying). At the same time, they reduce the risk of lubricant contamination.

---

## Grease pistols ..... 130

The range of grease pistols extends from simple grease pistols to volumetric metering pistols with digital flow rate measurement.

---

## Transport aids ..... 132

Carry grips and trolleys allow the mobile use of drum pumps at any location. Trolleys are available in different designs and for different container sizes.



0016F2E9



0016F0B8

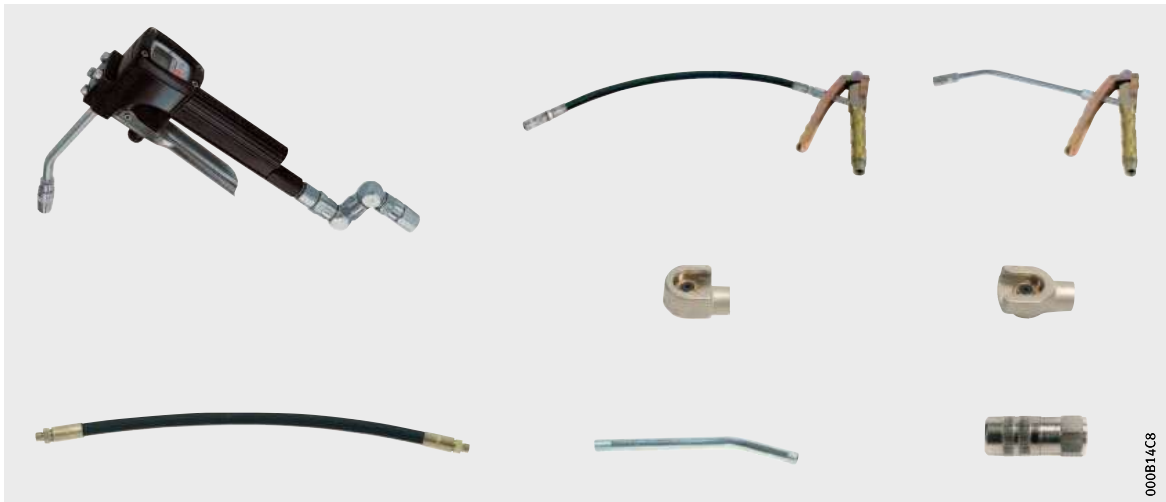

000B14C8



0016F512

# Lever grease gun



*Figure 1*  
Lever grease gun  
ARCA-GREASE-GUN

The lever grease gun ARCA-GREASE-GUN can be used to achieve high lubrication pressures without issue.

The proven TWIN-LOCK system protects the piston guide of the lever grease gun against wear-induced abrasion during continuous operation and thus prevents the risk of quasi-lubrication to machines and equipment.

The EVER-FLOW system ensures that the lever grease gun functions correctly even with highly viscous grease and very low temperatures. Due to the vacuum created during the pumping operation, even tough biological grease can be delivered easily.

## Technical data

Feature		Value
Fill quantity	Grease cartridge	400 g (up to NLGI 3)
	Loose grease	500 cm <sup>3</sup> (up to NLGI 3)
Operating pressure		400 bar
Delivery rate		≈ 1,9 cm <sup>3</sup> /Stroke length
Pressure pipe	Material	Steel, zinc-coated
	Diameter	56 mm
	Length	296 mm
Threaded connector		G <sup>1</sup> / <sub>8</sub>

**Type overview**  
**Lever grease gun**

Type	Ordering number	Ordering designation
Lever grease gun	039064115-0000-10	ARCA-GREASE-GUN

**Type overview**  
**Hose with plug-in coupling**

Hose including 4 jaw nozzle for taper type lubrication nipples to DIN 71412, threaded connector R<sup>1</sup>/<sub>8</sub> (both sides)



000B48E2

Type	Length L mm	Ordering number	Ordering designation
Hose	300	039064123-0000-10	ARCA-GREASE-GUN.HOSE

**Type overview**  
**Hose with slide coupling**

Hose including slide coupling, for button head lubrication nipples to DIN 3404-16, threaded connector R<sup>1</sup>/<sub>8</sub> (both sides)



000AE28F

Type	Length L mm	Ordering number	Ordering designation
Hose	300	039697010-0000-10	ARCA-GREASE-GUN.HOOK-ON-HOSE



# Lever grease gun

## Type overview Arcanol grease cartridges

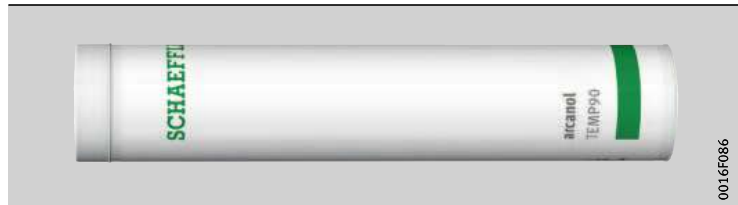

Type	Ordering number	Ordering designation
400 g cartridge containing		
Arcanol CLEAN-M	069429111-0000-10	ARCANOL-CLEAN-M-400G
Arcanol Food2	019143648-0000-10	ARCANOL-FOOD2-400G
Arcanol LOAD150	055358152-0000-10	ARCANOL-LOAD150-400G
Arcanol LOAD220	064741028-0000-10	ARCANOL-LOAD220-400G
Arcanol LOAD400	019143818-0000-11	ARCANOL-LOAD400-400G
Arcanol LOAD460	065825144-0000-10	ARCANOL-LOAD460-400G
Arcanol MULTI2	019143893-0000-11	ARCANOL-MULTI2-400G
Arcanol MULTI3	016727355-0000-11	ARCANOL-MULTI3-400G
Arcanol MULTITOP	019144016-0000-11	ARCANOL-MULTITOP-400G
Arcanol SEMIFLUID	096322918-0000-10	ARCANOL-SEMIFLUID-380G
Arcanol SPEED2,6	062447610-0000-10	ARCANOL-SPEED2,6-400G
Arcanol TEMP90	019144172-0000-10	ARCANOL-TEMP90-400G
Arcanol TEMP110	019144075-0000-10	ARCANOL-TEMP110-400G
Arcanol VIB3	055289568-0000-10	ARCANOL-VIB3-400G

### Further information

#### Technical Product Information:

- TPI 168 Arcanol Rolling Bearing Greases  
<https://www.schaeffler.de/std/1F66>

#### Datasheet:

- FAS Arcanol Rolling Bearing Greases  
<https://www.schaeffler.de/std/1F67>



# Drum pumps

- ① Pneumatic drum pump  
ARCA-PUMP-BARREL-180-S
- ② Metering pistol grease gun
- ③ High pressure hose
- ④ Manual drum pump  
ARCA-PUMP-BARREL-50-MANUAL
- ⑤ Refill nipple
- ⑥ Connecting piece
- ⑦ Dust cover
- ⑧ Follower piston

*Figure 1*  
Combination of drum pumps with  
grease containers and accessories  
(examples)



Manual and pneumatic drum pumps are suitable for delivering large quantities of grease under high pressure over long distances. However, they can also be used to fill the CONCEPT lubricators and associated cartridges.

When directly inserted in the original container, they facilitate economical use (less time required and optimal emptying). At the same time, they reduce the risk of lubricant contamination.

## Pneumatic drum pumps

The pneumatic drum pump ARCA-PUMP-BARREL-...-S is suitable for use in hobboscks with a fill quantity of 25 kg or 50 kg as well as for drums with 180 kg.

In the workshop, it can be used for:

- the filling of rolling bearings
- the greasing of gearboxes
- all applications that must be filled repeatedly with different grease quantities.

The pneumatic drum pump can be fitted either with a simple hand valve or with a metering pistol grease gun, see page 130.



## Manual drum pumps

The manual drum pump ARCA-PUMP-BARREL...-MANUAL is suitable for use in hobboscks with a fill quantity of 25 kg or 50 kg.

It is a cost-effective alternative to the pneumatic drum pump that can be used anywhere and is also used in particular for filling the lubricator CONCEPT1 and the cartridges from CONCEPT2, CONCEPT4 and CONCEPT8.

Refill nipples, see page 22, and a suitable connecting piece, see page 126, are available for connecting the lubricator CONCEPT1. Filling adapters, see page 67, are available for connecting the cartridges of CONCEPT2, CONCEPT4 and CONCEPT8.

## Drum pumps

### Technical data

Feature		Drum pump	
		pneumatic	manual
Connectors	Compressed air inlet	G <sup>1/4</sup> (internal thread)	–
	Grease outlet	G <sup>1/4</sup> (external thread)	
Suction pipe	Diameter	30 mm	
	Length	480 mm, 750 mm, 950 mm	480 mm, 750 mm
Operating pressure (at 6 bar pneumatic supply pressure)		4,2 bar	–
Pneumatic supply pressure	min.	3,5 bar	–
	max.	8,5 bar	–
Pressure ratio		70:1	–
Delivery rate		1 100 cm <sup>3</sup> /min	42 g/Stroke length
Maximum air consumption		150 l/min	–
Maximum consistency class		NLGI 2	NLGI 3
Grease temperature (NLGI 2)	min.	+10 °C	
	max.	+40 °C	
Sound pressure level		76 dB	–
Mass		5,46 kg, 6,37 kg, 7,1 kg	3,5 kg, 4,5 kg



# Drum pumps

## Type overview Pneumatic drum pumps

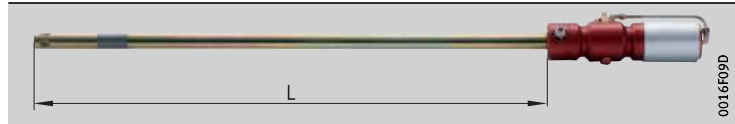

Suitable container kg	Length L mm	Ordering number	Ordering designation
25	480	065139470-0000-10	ARCA-PUMP-BARREL-25-S
50	750	065139542-0000-10	ARCA-PUMP-BARREL-50-S
180	950	065139550-0000-10	ARCA-PUMP-BARREL-180-S

## Type overview Manual drum pumps

Manual drum pump including fill nozzle (90°)



Suitable container kg	Length L mm	Ordering number	Ordering designation
25	480	095214038-0000-10	ARCA-PUMP-BARREL-25-MANUAL
50	750	095214054-0000-10	ARCA-PUMP-BARREL-50-MANUAL

**Type overview**  
**Dust cover**

Dust cover made from steel, powder coated, suction pipe diameter = 30 mm



0018F471

Suitable container kg	Container outside diameter mm		Ordering number	Ordering designation
	min.	max.		
25	300	350	065348524-0000-10	ARCA-PUMP-BARREL-25-S.LID
50	370	420	065349849-0000-10	ARCA-PUMP-BARREL-50-S.LID
180	550	600	065350863-0000-10	ARCA-PUMP-BARREL-180-S.LID

**Type overview**  
**Follower pistons**

Follower pistons made from steel, zinc-coated, with rubber seal lip, suction pipe diameter = 30 mm



0018F481

Suitable container kg	Container outside diameter mm		Ordering number	Ordering designation
	min.	max.		
25	300	330	065349687-0000-10	ARCA-PUMP-BARREL-25-S.FP
50	360	400	065350685-0000-10	ARCA-PUMP-BARREL-50-S.FP
180	540	580	065351592-0000-10	ARCA-PUMP-BARREL-180-S.FP



# Drum pumps

## Type overview High pressure hoses

Nominal pressure = 400 bar, burst pressure = 1 600 bar, connectors G <sup>1/4</sup> (1×internal thread, 1×external thread)		
		
Length L m	Ordering number	Ordering designation
2	065352270-0000-10	ARCA-PUMP-BARREL.HOSE-2M
3	065352432-0000-10	ARCA-PUMP-BARREL.HOSE-3M
5	065352866-0000-10	ARCA-PUMP-BARREL.HOSE-5M
10	065353153-0000-10	ARCA-PUMP-BARREL.HOSE-10M

0018F159

## Type overview Connecting piece

Connecting piece, for connecting the refill nipple ARCALUB-C1.NIPPLE-REFILL-GREASE-R1/4 to the filling nozzle of the drum pump		
		
Thread	Ordering number	Ordering designation
G <sup>1/4</sup>	095291598-0000-10	ARCALUB-C1.CONNECT-G1/4

0018D865

10 pieces per packaging unit.

**Type overview  
Arcanol hobbocks  
25 kg**



0018DD26

Type	Ordering number	Ordering designation
Hobbock (25 kg) containing		
Arcanol FOOD2	019143630-0000-10	ARCANOL-FOOD2-25KG#K
Arcanol LOAD220	019143761-0000-10	ARCANOL-LOAD220-25KG#K
Arcanol LOAD400	019143800-0000-11	ARCANOL-LOAD400-25KG#K
Arcanol LOAD460	065827066-0000-10	ARCANOL-LOAD460-25KG#S
Arcanol MOTION2	080267009-0000-10	ARCANOL-MOTION2-25KG#S
Arcanol MULTI2	019143885-0000-10	ARCANOL-MULTI2-25KG#K
Arcanol MULTITOP	019144008-0000-11	ARCANOL-MULTITOP-25KG#K
Arcanol TEMP120	019144105-0000-10	ARCANOL-TEMP120-25KG#K

**Type overview  
Arcanol hobbocks  
50 kg**



0018DD27

Type	Ordering number	Ordering designation
Hobbock (50 kg) containing		
Arcanol LOAD150	059810025-0000-10	ARCANOL-LOAD150-50KG
Arcanol LOAD400	019143826-0000-11	ARCANOL-LOAD400-50KG
Arcanol LOAD460	065827120-0000-10	ARCANOL-LOAD460-50KG
Arcanol MOTION2	080267157-0000-10	ARCANOL-MOTION2-50KG
Arcanol TEMP110	038705478-0000-10	ARCANOL-TEMP110-50KG

**Further information**

**Technical Product Information:**

- TPI 168 Arcanol Rolling Bearing Greases  
<https://www.schaeffler.de/std/1F66>

**Datasheet:**

- FAS Arcanol Rolling Bearing Greases  
<https://www.schaeffler.de/std/1F67>



# Drum pumps

## Ordering examples

When ordering, the components must be selected according to the application and the size of the grease container. The ordering designation and ordering number must always be stated.

### Example 1

Hobcock containing 25 kg, distance to lubrication point max. 5 m, hobcock must be moved to different locations, lubricant quantity must be metered.

- ① Drum pump
- ② Dust cover
- ③ Follower piston
- ④ High pressure hose
- ⑤ Metering pistol grease gun
- ⑥ Trolley

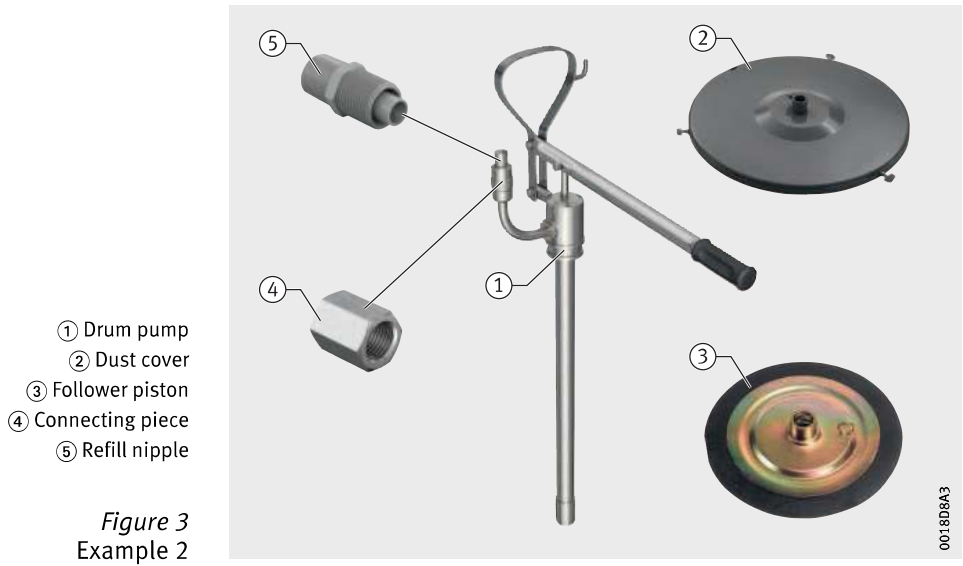

Figure 2  
Example 1

### Ordering

Item	Ordering		
	Quantity	Ordering number	Ordering designation
①	1	065139470-0000-10	ARCA-PUMP-BARREL-25-S
②	1	065348524-0000-10	ARCA-PUMP-BARREL-25-S.LID
③	1	065349687-0000-10	ARCA-PUMP-BARREL-25-S.FP
④	1	065352866-0000-10	ARCA-PUMP-BARREL.HOSE-5M
⑤	1	065353269-0000-10	ARCA-PUMP-BARREL.GUN-METER
⑥	1	077464036-0000-10	ARCA-PUMP-BARREL-25-S.TROLLEY

**Example 2** Hobcock containing 50 kg, manual filling of cartridges of lubricator CONCEPT1, hobcock is stationary in the room.



- ① Drum pump
- ② Dust cover
- ③ Follower piston
- ④ Connecting piece
- ⑤ Refill nipple

*Figure 3*  
Example 2

**Ordering**

Item	Ordering		
	Quantity	Ordering number	Ordering designation
①	1	095214054-0000-10	ARCA-PUMP-BARREL-50-MANUAL
②	1	065349849-0000-10	ARCA-PUMP-BARREL-50-S.LID
③	1	065350685-0000-10	ARCA-PUMP-BARREL-50-S.FP
④	1	095291598-0000-10	ARCALUB-C1.CONNECT-G1/4
⑤	1	095248161-0000-10	ARCALUB-C1.NIPPLE-REFILL-GREASE-R1/4



# Grease pistols

## Type overview Metering pistol grease gun with digital flow rate measurement

Z type swivel joint G<sup>1/4</sup>, nozzle tube of length = 150 mm, 4 jaw nozzle, threaded connector M10×1 (for hose or nozzle tube)



000AE439

Type	Ordering number	Ordering designation
Metering pistol grease gun	065353269-0000-10	ARCA-PUMP-BARREL.GUN-METER

## Technical data Metering pistol grease gun

Feature	Value
Operating pressure	≅ 550 bar
Delivery rate	≅ 2,5 kg/min
Counting accuracy	± 3%

The metering pistol grease gun with digital flow rate measurement allows precise grease feed into bearing positions and gearboxes. The counter displays the grease quantity with an accuracy of 0,1 g and up to a maximum of 999 g per measurement operation. The grease quantity is measured by volume. Before starting volume application, metering pistol grease guns must be set once with the aid of a precision balance.

## Type overview Grease pistols without flow rate measurement

Axial swivel joint G<sup>1/4</sup>, 4 jaw nozzle, threaded connector M10×1 (for hose or nozzle tube)



000AE549

Type	Hose length mm	Ordering number	Ordering designation
A	400	065353617-0000-10	ARCA-PUMP-BARREL.GUN-H
B	150	065353323-0000-10	ARCA-PUMP-BARREL.GUN-P



**Type overview**  
**Accessories for grease pistols**

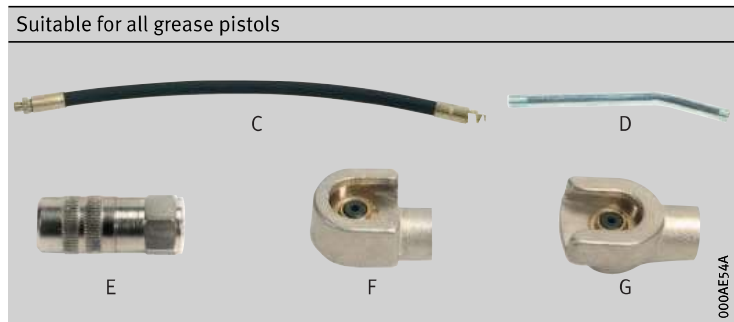

Type	Ordering number	Ordering designation
C   Hose	077464478-0000-10	ARCA-PUMP-BARREL-S.GUN-HOSE
D   Nozzle tube	077464648-0000-10	ARCA-PUMP-BARREL-S.GUN-PIPE
E   4 jaw nozzle	077465130-0000-10	ARCA-PUMP-BARREL-S.FIT-4-JAWS
F   Slide coupling	077590465-0000-10	ARCA-PUMP-BARREL-S.FIT-HEX16
G   Slide coupling	077590600-0000-10	ARCA-PUMP-BARREL-S.FIT-HEX16P

**Technical data**  
**Accessories for grease pistols**  
**Type C, D, E**

Feature	Type		
	C	D	E
	Hose	Nozzle tube	4 jaw nozzle
Thread	Both sides M10×1, external thread	Both sides M10×1, external thread	M10×1, Internal thread
Length	400 mm	150 mm	–
Suitable lubrication nipple	–	–	Taper type lubrication nipple

**Technical data**  
**Accessories for grease pistols**  
**Type F, G**

Feature	Type	
	F	G
	Slide coupling	Slide coupling
Design	For pulling	For insertion
Thread	M10×1, Internal thread	M10×1, Internal thread
Suitable lubrication nipple	Button head lubrication nipple, head diameter = 16 mm	Button head lubrication nipple, head diameter = 16 mm



# Transport aids

## Type overview Transport aids



Type	Ordering number	Ordering designation
A Carry grip for drum pumps	065353803-0000-10	ARCA-PUMP-BARREL-S.HANDLE
B Trolley for containers	077464036-0000-10	ARCA-PUMP-BARREL-25-S.TROLLEY
C Trolley for drums	074444239-0000-10	ARCA-PUMP-BARREL-50-S.TROLLEY

## Technical data Transport aids

Feature	Type		
	A	B	C
Transport of	Drum pumps	Containers <sup>1)</sup>	Drums <sup>2)</sup>
Material	Steel, zinc-coated	Steel, powder coated	Steel, powder coated
Dimensions mm	430×190×65	480×500-680×980	545×640×910
Mass kg	0,6	5,9	13,7
Rollers	–	2 pieces, Ø 150 mm	2 pieces, Ø 150 mm
Swivel castors	–	–	2 pieces, Ø 60 mm

<sup>1)</sup> Suitable for containers with a mass of 20 kg to 60 kg.

<sup>2)</sup> Suitable for drums with a diameter up to 410 mm and a mass of 50 kg to 60 kg.



# Article list

<b>Electrochemical lubricators</b>		
Ordering designation	Ordering number	Page
<b>With drive unit, prefilled for grease lubrication</b>		
ARCALUB-C1-60-FOOD2	095249290-0000-10	18
ARCALUB-C1-60-LOAD220	095249273-0000-10	18
ARCALUB-C1-60-LOAD400	095249249-0000-10	18
ARCALUB-C1-60-MULTI2	095249230-0000-10	18
ARCALUB-C1-60-MULTITOP	095249222-0000-10	18
ARCALUB-C1-60-TEMP110	095249214-0000-10	18
ARCALUB-C1-125-FOOD2	095248897-0000-10	18
ARCALUB-C1-125-LOAD150	095731784-0000-10	18
ARCALUB-C1-125-LOAD220	095248870-0000-10	18
ARCALUB-C1-125-LOAD400	095248854-0000-10	18
ARCALUB-C1-125-LOAD460	095248838-0000-10	18
ARCALUB-C1-125-MULTI2	095248820-0000-10	18
ARCALUB-C1-125-MULTITOP	095248811-0000-10	18
ARCALUB-C1-125-TEMP110	095248200-0000-10	18
<b>With drive unit, prefilled for oil lubrication</b>		
ARCALUB-C1-60-CHAIN-OIL	096040432-0000-10	18
ARCALUB-C1-125-CHAIN-OIL	095248900-0000-10	18
ARCALUB-C1-125-FOOD-OIL	095248889-0000-10	18
<b>With drive unit, unfilled</b>		
ARCALUB-C1-60-REFILLABLE	095166050-0000-10	20
ARCALUB-C1-125-REFILLABLE	095166076-0000-10	20
<b>Refilling kits</b>		
ARCALUB-C1.DRYCELL-KIT-60	095287523-0000-10	21
ARCALUB-C1.DRYCELL-KIT-125	095287540-0000-10	21
<b>Filling accessories</b>		
ARCALUB-C1.NIPPLE-REFILL-G1/4	095248170-0000-10	22
ARCALUB-C1.NIPPLE-REFILL-GREASE-R1/4	095248161-0000-10	22
ARCALUB-C1.NIPPLE-REFILL-GREASE-R3/8	095248137-0000-10	22
ARCALUB-C1.PLUG-OIL-VALVE	095286780-0000-10	22
<b>Reducing nipples</b>		
ARCALUB-C1.NIPPLE-G1/8-G1/4	095285792-0000-10	27
ARCALUB-C1.NIPPLE-G1/4-G1/4	095285784-0000-10	27
ARCALUB-C1.NIPPLE-G3/8-G1/4	095285806-0000-10	27
ARCALUB-C1.NIPPLE-M6-G1/4	095286071-0000-10	27
ARCALUB-C1.NIPPLE-M8-G1/4	095286080-0000-10	27
ARCALUB-C1.NIPPLE-M8X1-G1/4	095301585-0000-10	27
ARCALUB-C1.NIPPLE-M10-G1/4	095286101-0000-10	27
ARCALUB-C1.NIPPLE-M10X1-G1/4	095286721-0000-10	27
ARCALUB-C1.NIPPLE-M12-G1/4	095286730-0000-10	27
ARCALUB-C1.NIPPLE-M12X1,5-G1/4	095286748-0000-10	27
ARCALUB-C1.NIPPLE-UNF1/4-G1/4	095286756-0000-10	27

<b>Electrochemical lubricators</b>		
Ordering designation	Ordering number	Page
<b>Extensions</b>		
ARCALUB-C1.EXTEND-35MM-G1/4	095285725-0000-10	27
ARCALUB-C1.EXTEND-50MM-G1/4	095285733-0000-10	27
<b>Connecting pieces</b>		
ARCALUB-C1.CONNECT-45-G1/4-IA	095285393-0000-10	28
ARCALUB-C1.CONNECT-90-G1/4-IA	095285407-0000-10	28
<b>Hose</b>		
ARCALUB-C1.HOSE-8X6-PA12-5M	095285750-0000-10	28
<b>Check valve</b>		
ARCALUB-C1.CONNECT-OIL-VALVE-G1/4	095287515-0000-10	29
<b>Hose connector part</b>		
ARCALUB-C1.TUBEFIT-G1/4I-SAT148G	095287051-0000-10	29
<b>Device holders</b>		
ARCALUB-C1.CLAMP	095285377-0000-10	31
ARCALUB-C1.CLAMP-MAGNET	095285385-0000-10	31
ARCALUB-C1.MOUNT-SUPPORT-R1/4	095285768-0000-10	31
ARCALUB-C1.FIXING-ANGLE	095285741-0000-10	31
ARCALUB-C1.FIXINGSCREW-G1/2-R1/4	096691620-0000-10	31
<b>Protective accessories</b>		
ARCALUB-C1.COVER	095285717-0000-10	32
<b>2-way adapter</b>		
ARCALUB-C1.ADAPTER-TWIN	095285326-0000-10	32
<b>Brushes</b>		
ARCALUB-C1.BRUSH-25MM-G1/4-G	095285334-0000-10	33
ARCALUB-C1.BRUSH-40MM-G1/4-G	095285342-0000-10	33
ARCALUB-C1.BRUSH-70MM-G1/4-G	095285350-0000-10	33
ARCALUB-C1.BRUSH-100MM-G1/4-G	095285369-0000-10	33
<b>Spare parts</b>		
ARCALUB-C1.SEAL	095286802-0000-10	34
ARCALUB-C1.SEAL-CAP	095287043-0000-10	34
<b>Demo case</b>		
DEMO-ARCALUB-C1-SET	095287558-0000-10	36
<b>Starter kit</b>		
ARCALUB-C1-KIT001	095463860-0000-10	38



## Article list

<b>Electromechanical lubricators</b>		
Ordering designation	Ordering number	Page
<b>CONCEPT2</b>		
ARCALUB-C2-2P	086872931-0000-10	44
ARCALUB-C2-2P-24VDC	086873105-0000-10	44
ARCALUB-C2-2P-OIL-24VDC	092246265-0000-10	44
<b>CONCEPT4</b>		
ARCALUB-C4-2P-24VDC	094901589-0000-10	50
<b>CONCEPT8</b>		
ARCALUB-C8-2P	082249156-0000-10	56
ARCALUB-C8-4P	082266646-0000-10	56
ARCALUB-C8-2P-OIL	083786910-0000-10	56
ARCALUB-C8-4P-OIL	083787062-0000-10	56
<b>Cartridges, filled with Arcanol grease</b>		
ARCALUB-C2.LC250-CLEAN-M	087334194-0000-10	60
ARCALUB-C2.LC250-FOOD2	087334020-0000-10	60
ARCALUB-C2.LC250-LOAD150	087329077-0000-10	60
ARCALUB-C2.LC250-LOAD220	087329115-0000-10	60
ARCALUB-C2.LC250-LOAD400	087329131-0000-10	60
ARCALUB-C2.LC250-LOAD460	087329140-0000-10	60
ARCALUB-C2.LC250-LOAD1000	087329280-0000-10	60
ARCALUB-C2.LC250-MULTI2	087328038-0000-10	60
ARCALUB-C2.LC250-MULTITOP	087328810-0000-10	60
ARCALUB-C2.LC250-MOTION2	087334216-0000-10	60
ARCALUB-C2.LC250-SEMIFLUID	095195831-0000-10	60
ARCALUB-C2.LC250-SPEED2,6	087334046-0000-10	60
ARCALUB-C2.LC250-TEMP90	087329816-0000-10	60
ARCALUB-C2.LC250-TEMP110	087329840-0000-10	60
ARCALUB-C2.LC250-TEMP120	087329980-0000-10	60
ARCALUB-C2.LC250-TEMP200	087329999-0000-10	60
ARCALUB-C4.LC400-CLEAN-M	095058125-0000-10	61
ARCALUB-C4.LC400-EM-L038	095058141-0000-10	61
ARCALUB-C4.LC400-FOOD2	095058117-0000-10	61
ARCALUB-C4.LC400-LOAD150	095056785-0000-10	61
ARCALUB-C4.LC400-LOAD220	095056793-0000-10	61
ARCALUB-C4.LC400-LOAD400	095056807-0000-10	61
ARCALUB-C4.LC400-LOAD460	095058010-0000-10	61
ARCALUB-C4.LC400-LOAD1000	095058028-0000-10	61
ARCALUB-C4.LC400-MULTI2	095056769-0000-10	61
ARCALUB-C4.LC400-MULTI3	095056750-0000-10	61
ARCALUB-C4.LC400-MULTITOP	095056777-0000-10	61
ARCALUB-C4.LC400-MOTION2	095058133-0000-10	61
ARCALUB-C4.LC400-SEMIFLUID	095195823-0000-10	61
ARCALUB-C4.LC400-SPEED2,6	095058087-0000-10	61
ARCALUB-C4.LC400-TEMP90	095058044-0000-10	61
ARCALUB-C4.LC400-TEMP110	095058052-0000-10	61
ARCALUB-C4.LC400-TEMP120	095058060-0000-10	61
ARCALUB-C4.LC400-TEMP200	095058079-0000-10	61
ARCALUB-C4.LC400-VIB3	095058095-0000-10	61

<b>Electromechanical lubricators</b>		
Ordering designation	Ordering number	Page
<b>Cartridges, filled with Arcanol grease</b>		
ARCALUB-C8.LC800-CLEAN-M	083549129-0000-10	62
ARCALUB-C8.LC800-FOOD2	083549064-0000-10	62
ARCALUB-C8.LC800-LOAD150	083532439-0000-10	62
ARCALUB-C8.LC800-LOAD220	083533583-0000-10	62
ARCALUB-C8.LC800-LOAD400	083533761-0000-10	62
ARCALUB-C8.LC800-LOAD460	083533818-0000-10	62
ARCALUB-C8.LC800-LOAD1000	083548343-0000-10	62
ARCALUB-C8.LC800-MULTI2	083532412-0000-10	62
ARCALUB-C8.LC800-MULTI3	083548289-0000-10	62
ARCALUB-C8.LC800-MULTITOP	082631492-0000-10	62
ARCALUB-C8.LC800-SEMIFLUID	095195815-0000-10	62
ARCALUB-C8.LC800-SPEED2,6	083548629-0000-10	62
ARCALUB-C8.LC800-TEMP90	083533630-0000-10	62
ARCALUB-C8.LC800-TEMP110	083548580-0000-10	62
ARCALUB-C8.LC800-TEMP120	083548599-0000-10	62
ARCALUB-C8.LC800-TEMP200	083548602-0000-10	62
ARCALUB-C8.LC800-VIB3	083549099-0000-10	62
<b>Refillable grease cartridges</b>		
ARCALUB-C2.LC250-REFILLABLE	095028803-0000-10	66
ARCALUB-C4.LC400-REFILLABLE	095058036-0000-10	66
ARCALUB-C8.LC800-REFILLABLE	095028790-0000-10	66
<b>Closing plugs</b>		
ARCALUB-C2.LC250-SEAL-CAP	095179879-0000-10	66
ARCALUB-C4.LC400-SEAL-CAP	095179887-0000-10	66
ARCALUB-C8.LC800-SEAL-CAP	095179895-0000-10	66
<b>Filling adapters</b>		
ARCALUB-C2.LC250-RF-ADAPTER	095179909-0000-10	67
ARCALUB-C4.LC400-RF-ADAPTER	095180818-0000-10	67
ARCALUB-C8.LC800-RF-ADAPTER	095180826-0000-10	67
<b>Voltage supply</b>		
ARCALUB-C2.BATTERY	087314762-0000-10	70
ARCALUB-X.CABLE-M12-10M	075378361-0000-10	70
ARCALUB-X.CABLE-M12X1-5M-LED-S	083788964-0000-10	70
ARCALUB-X.CABLE-M12X1-10M-LED-S	083788980-0000-10	70
ARCALUB-X.CABLE-M12-5M-LED	075592240-0000-10	70
ARCALUB-X.CABLE-M12-10M-LED	077879805-0000-10	70
<b>Device holders</b>		
ARCALUB-C2.HOLDER-KIT	092435726-0000-10	74
ARCALUB-C8.HOLDER-KIT	093204094-0000-10	74
<b>Splitters, progressive distributors</b>		
ARCALUB-X.SPLITTER-2X-STRAIGHT-GREASE	081307497-0000-10	76
ARCALUB-X.SPLITTER-2X-STRAIGHT-OIL	074969218-0000-10	76
ARCALUB-X.PROGDIV-3X-RIGHT-0.05CCM	093204060-0000-10	78



## Article list

<b>Electromechanical lubricators</b>		
Ordering designation	Ordering number	Page
<b>Hose connectors</b>		
ARCALUB-X.CONNECT-4-4	095770887-0000-10	80
ARCALUB-X.CONNECT-6-4	093040717-0000-10	80
ARCALUB-X.CONNECT-6-6	083867112-0000-10	80
ARCALUB-X.CONNECT-8-6	083867279-0000-10	80
ARCALUB-X.CONNECT-8-8	083867309-0000-10	80
ARCALUB-X.CONNECT-4-4-W	095770895-0000-10	80
ARCALUB-X.CONNECT-6-6-W	088902250-0000-10	80
ARCALUB-X.TUBEFIT-CONNECT-8-8-W	094927723-0000-10	80
<b>Y pieces</b>		
ARCALUB-X.TUBEFIT-Y-D6	076693180-0000-10	81
ARCALUB-X.TUBEFIT-Y-D8	083654640-0000-10	81
<b>Check valve</b>		
ARCALUB-X.OIL-VALVE-SAT106G	092927122-0000-10	81
<b>Connection adapters</b>		
ARCALUB-X.TUBEFIT-SAT8A6I	094487979-0000-10	82
ARCALUB-X.TUBEFIT-SAT-8A-4I	095777970-0000-10	82
ARCALUB-X.TUBEFIT-SAT-6A-4I	095777962-0000-10	82
ARCALUB-X.TUBEFIT-SAT-6A-6I-W	095058150-0000-10	82
ARCALUB-X.TUBEFIT-SAT-8A-8I-W	095058168-0000-10	82
<b>Hose connector parts</b>		
ARCALUB-X.TUBEFIT-M3-SAT034G-S	093041390-0000-10	84
ARCALUB-X.TUBEFIT-M6-SAT064G	095777636-0000-10	84
ARCALUB-X.TUBEFIT-M10X1-SAT104G	095777911-0000-10	84
ARCALUB-X.TUBEFIT-M5-SAT056G	077937490-0000-10	84
ARCALUB-X.TUBEFIT-M6-SAT066G	075527472-0000-10	84
ARCALUB-X.TUBEFIT-M8X1-SAT086G	079567428-0000-10	84
ARCALUB-X.TUBEFIT-M10X1-SAT106G	075527626-0000-10	84
ARCALUB-X.TUBEFIT-G1/8-SAT186G	084465905-0000-10	84
ARCALUB-X.TUBEFIT-G1/4-SAT146G	079567606-0000-10	84
ARCALUB-X.TUBEFIT-M8X1-SAT088G	083654216-0000-10	84
ARCALUB-X.TUBEFIT-M10X1-SAT108G	083654356-0000-10	84
ARCALUB-X.TUBEFIT-G1/8-SAT188G	083654534-0000-10	84
ARCALUB-X.TUBEFIT-G1/4-SAT148G	083654607-0000-10	84
ARCALUB-X.TUBEFIT-M6-SAT064W	095777644-0000-10	86
ARCALUB-X.TUBEFIT-M10X1-SAT104W	095777954-0000-10	86
ARCALUB-X.TUBEFIT-M5-SAT056W	079567401-0000-10	86
ARCALUB-X.TUBEFIT-M6-SAT066W	075676621-0000-10	86
ARCALUB-X.TUBEFIT-M8X1-SAT086W	079567584-0000-10	86
ARCALUB-X.TUBEFIT-M10X1-SAT106W	076968553-0000-10	86
ARCALUB-X.TUBEFIT-G1/8-SAT186W	084465964-0000-10	86
ARCALUB-X.TUBEFIT-G1/4-SAT146W	079567622-0000-10	86
ARCALUB-X.TUBEFIT-M8X1-SAT088W	083654275-0000-10	86
ARCALUB-X.TUBEFIT-M10X1-SAT108W	083654402-0000-10	86
ARCALUB-X.TUBEFIT-G1/8-SAT188W	083654577-0000-10	86
ARCALUB-X.TUBEFIT-G1/4-SAT148W	083654623-0000-10	86



<b>Electromechanical lubricators</b>		
Ordering designation	Ordering number	Page
<b>Hoses, hose cutters</b>		
ARCALUB-X.HOSE-4X2,5-PA12-5M	093041241-0000-10	88
ARCALUB-X.HOSE-4X2,5-PA12-10M	093041195-0000-10	88
ARCALUB-X.HOSE-4X2,5-PA12-50M	095775854-0000-10	88
ARCALUB-X.HOSE-PA12-5M	076691217-0000-10	88
ARCALUB-X.HOSE-PA12-10M	076691497-0000-10	88
ARCALUB-X.HOSE-PA12-50M	085842109-0000-10	88
ARCALUB-X.HOSE-PA66-5M	083788573-0000-10	88
ARCALUB-X.HOSE-PA66-10M	083788581-0000-10	88
ARCALUB-X.HOSE-PA66-50M	083788603-0000-10	88
ARCALUB-X.HOSE-PA12-CLEAR-5M	075526336-0000-10	89
ARCALUB-X.HOSE-PA12-CLEAR-10M	083788441-0000-10	89
ARCALUB-X.HOSE-PA12-CLEAR-25M	075527251-0000-10	89
ARCALUB-X.HOSE-PA12-CLEAR-1000M	092515851-0000-10	89
ARCALUB-X.HOSE-CUTTOOL	083788620-0000-10	89
<b>Demo cases</b>		
DEMO-ARCALUB-C2-SET	089395433-0000-10	91
DEMO-ARCALUB-C8-SET	084224878-0000-10	91
<b>Complete packages</b>		
ARCALUB-C2-2P-EKIT	092662269-0000-10	92
ARCALUB-C2-2P-24VDC-EKIT	092662277-0000-10	92
<b>Seal kit for CONCEPT8</b>		
ARCALUB-C8.SEAL-KIT	094977291-0000-10	93
<b>Cover kits</b>		
ARCALUB-C2.COVER-KIT	092860915-0000-10	94
ARCALUB-C4.COVER-KIT	095111930-0000-10	94
ARCALUB-C8.COVER-KIT	095111948-0000-10	94



## Article list

<b>Accessories for lubricant application</b>		
Ordering designation	Ordering number	Page
<b>Lubrication gears</b>		
ARCALUB-X.PINION-MD1,5-Z24-B15-G-G	093283016-0000-10	100
ARCALUB-X.PINION-MD2,0-Z17-B20-G-G	093283032-0000-10	100
ARCALUB-X.PINION-MD3,0-Z17-B30-G-G	093283059-0000-10	100
ARCALUB-X.PINION-MD4,0-Z17-B40-G-G	093283075-0000-10	100
ARCALUB-X.PINION-MD5,0-Z17-B50-G-G	093283091-0000-10	100
ARCALUB-X.PINION-MD6,0-Z17-B60-G-G	093283113-0000-10	100
ARCALUB-X.PINION-MD8,0-Z17-B80-G-G	093283130-0000-10	100
ARCALUB-X.PINION-MD10,0-Z17-B100-G-G	093283156-0000-10	100
ARCALUB-X.PINION-MD1,5-Z24-B15-G-W	093283024-0000-10	100
ARCALUB-X.PINION-MD2,0-Z17-B20-G-W	093283040-0000-10	100
ARCALUB-X.PINION-MD3,0-Z17-B30-G-W	093283067-0000-10	100
ARCALUB-X.PINION-MD4,0-Z17-B40-G-W	093283083-0000-10	100
ARCALUB-X.PINION-MD5,0-Z17-B50-G-W	093283105-0000-10	100
ARCALUB-X.PINION-MD6,0-Z17-B60-G-W	093283121-0000-10	100
ARCALUB-X.PINION-MD8,0-Z17-B80-G-W	093283148-0000-10	100
ARCALUB-X.PINION-MD10,0-Z17-B100-G-W	093283164-0000-10	100
ARCALUB-X.PINION-MD1,5-Z24-B15-SR-G	093283172-0000-10	102
ARCALUB-X.PINION-MD2,0-Z17-B20-SR-G	093283199-0000-10	102
ARCALUB-X.PINION-MD3,0-Z17-B30-SR-G	093283210-0000-10	102
ARCALUB-X.PINION-MD4,0-Z17-B40-SR-G	093283237-0000-10	102
ARCALUB-X.PINION-MD5,0-Z17-B50-SR-G	093283253-0000-10	102
ARCALUB-X.PINION-MD6,0-Z17-B60-SR-G	093283270-0000-10	102
ARCALUB-X.PINION-MD8,0-Z17-B80-SR-G	093283296-0000-10	102
ARCALUB-X.PINION-MD10,0-Z17-B100-SR-G	093283318-0000-10	102
ARCALUB-X.PINION-MD1,5-Z24-B15-SR-W	093283180-0000-10	102
ARCALUB-X.PINION-MD2,0-Z17-B20-SR-W	093283202-0000-10	102
ARCALUB-X.PINION-MD3,0-Z17-B30-SR-W	093283229-0000-10	102
ARCALUB-X.PINION-MD4,0-Z17-B40-SR-W	093283245-0000-10	102
ARCALUB-X.PINION-MD5,0-Z17-B50-SR-W	093283261-0000-10	102
ARCALUB-X.PINION-MD6,0-Z17-B60-SR-W	093283288-0000-10	102
ARCALUB-X.PINION-MD8,0-Z17-B80-SR-W	093283300-0000-10	102
ARCALUB-X.PINION-MD10,0-Z17-B100-SR-W	093283326-0000-10	102

<b>Accessories for lubricant application</b>		
Ordering designation	Ordering number	Page
<b>Lubrication gears</b>		
ARCALUB-X.PINION-MD1,5-Z24-B15-SL-G	093283334-0000-10	104
ARCALUB-X.PINION-MD2,0-Z17-B20-SL-G	093283350-0000-10	104
ARCALUB-X.PINION-MD3,0-Z17-B30-SL-G	093283377-0000-10	104
ARCALUB-X.PINION-MD4,0-Z17-B40-SL-G	093283393-0000-10	104
ARCALUB-X.PINION-MD5,0-Z17-B50-SL-G	093283415-0000-10	104
ARCALUB-X.PINION-MD6,0-Z17-B60-SL-G	093283431-0000-10	104
ARCALUB-X.PINION-MD8,0-Z17-B80-SL-G	093283458-0000-10	104
ARCALUB-X.PINION-MD10,0-Z17-B100-SL-G	093283474-0000-10	104
ARCALUB-X.PINION-MD1,5-Z24-B15-SL-W	093283342-0000-10	104
ARCALUB-X.PINION-MD2,0-Z17-B20-SL-W	093283369-0000-10	104
ARCALUB-X.PINION-MD3,0-Z17-B30-SL-W	093283385-0000-10	104
ARCALUB-X.PINION-MD4,0-Z17-B40-SL-W	093283407-0000-10	104
ARCALUB-X.PINION-MD5,0-Z17-B50-SL-W	093283423-0000-10	104
ARCALUB-X.PINION-MD6,0-Z17-B60-SL-W	093283440-0000-10	104
ARCALUB-X.PINION-MD8,0-Z17-B80-SL-W	093283466-0000-10	104
ARCALUB-X.PINION-MD10,0-Z17-B100-SL-W	093283482-0000-10	104
<b>Chain lubrication pinions</b>		
ARCALUB-X.CHAIN-PINION-08AB1-Z12-G	093283490-0000-10	108
ARCALUB-X.CHAIN-PINION-10AB1-Z10-G	093283547-0000-10	108
ARCALUB-X.CHAIN-PINION-12B1-Z8-G	093283601-0000-10	108
ARCALUB-X.CHAIN-PINION-16B1-Z8-G	093283652-0000-10	108
ARCALUB-X.CHAIN-PINION-08AB1-Z12-W	093283504-0000-10	108
ARCALUB-X.CHAIN-PINION-10AB1-Z10-W	093283555-0000-10	108
ARCALUB-X.CHAIN-PINION-12B1-Z8-W	093283610-0000-10	108
ARCALUB-X.CHAIN-PINION-16B1-Z8-W	093283660-0000-10	108
ARCALUB-X.CHAIN-PINION-08AB1-Z12-WF	093283512-0000-10	108
ARCALUB-X.CHAIN-PINION-10AB1-Z10-WF	093283563-0000-10	108
ARCALUB-X.CHAIN-PINION-16B1-Z8-WF	093283679-0000-10	108
ARCALUB-X.CHAIN-PINION-08AB2-Z12-G	093283520-0000-10	110
ARCALUB-X.CHAIN-PINION-10AB2-Z10-G	093283571-0000-10	110
ARCALUB-X.CHAIN-PINION-12B2-Z8-G	093283628-0000-10	110
ARCALUB-X.CHAIN-PINION-16B2-Z8-G	093283687-0000-10	110
ARCALUB-X.CHAIN-PINION-08AB2-Z12-W	093283539-0000-10	110
ARCALUB-X.CHAIN-PINION-10AB2-Z10-W	093283580-0000-10	110
ARCALUB-X.CHAIN-PINION-12B2-Z8-W	093283636-0000-10	110
ARCALUB-X.CHAIN-PINION-16B2-Z8-W	093283695-0000-10	110
ARCALUB-X.CHAIN-PINION-10AB2-Z10-WF	093283598-0000-10	110
ARCALUB-X.CHAIN-PINION-12B2-Z8-WF	093283644-0000-10	110
ARCALUB-X.CHAIN-PINION-16B2-Z8-WF	093283709-0000-10	110
<b>Lubrication rollers</b>		
ARCALUB-X.ROLE-D30-B45-WF	093283717-0000-10	113
ARCALUB-X.ROLE-D40-B30-WF	093283725-0000-10	113
ARCALUB-X.ROLE-D50-B40-WF	093283733-0000-10	113
ARCALUB-X.ROLE-D50-B60-WF	093283741-0000-10	113
ARCALUB-X.ROLE-D60-B45-WF	093283750-0000-10	113



## Article list

<b>Manual lubrication tools</b>		
Ordering designation	Ordering number	Page
Lever grease gun and accessories		
ARCA-GREASE-GUN	039064115-0000-10	119
ARCA-GREASE-GUN.HOSE	039064123-0000-10	119
ARCA-GREASE-GUN.HOOK-ON-HOSE	039697010-0000-10	119
Arcanol grease cartridges		
ARCANOL-CLEAN-M-400G	069429111-0000-10	120
ARCANOL-FOOD2-400G	019143648-0000-10	120
ARCANOL-LOAD150-400G	055358152-0000-10	120
ARCANOL-LOAD220-400G	064741028-0000-10	120
ARCANOL-LOAD400-400G	019143818-0000-11	120
ARCANOL-LOAD460-400G	065825144-0000-10	120
ARCANOL-MULTI2-400G	019143893-0000-11	120
ARCANOL-MULTI3-400G	016727355-0000-11	120
ARCANOL-MULTITOP-400G	019144016-0000-11	120
ARCANOL-SEMIFLUID-380G	096322918-0000-10	120
ARCANOL-SPEED2,6-400G	062447610-0000-10	120
ARCANOL-TEMP90-400G	019144172-0000-10	120
ARCANOL-TEMP110-400G	019144075-0000-10	120
ARCANOL-VIB3-400G	055289568-0000-10	120
Drum pumps and accessories		
ARCA-PUMP-BARREL-25-S	065139470-0000-10	124
ARCA-PUMP-BARREL-50-S	065139542-0000-10	124
ARCA-PUMP-BARREL-180-S	065139550-0000-10	124
ARCA-PUMP-BARREL-25-MANUAL	095214038-0000-10	124
ARCA-PUMP-BARREL-50-MANUAL	095214054-0000-10	124
ARCA-PUMP-BARREL-25-S.LID	065348524-0000-10	125
ARCA-PUMP-BARREL-50-S.LID	065349849-0000-10	125
ARCA-PUMP-BARREL-180-S.LID	065350863-0000-10	125
ARCA-PUMP-BARREL-25-S.FP	065349687-0000-10	125
ARCA-PUMP-BARREL-50-S.FP	065350685-0000-10	125
ARCA-PUMP-BARREL-180-S.FP	065351592-0000-10	125
ARCA-PUMP-BARREL.HOSE-2M	065352270-0000-10	126
ARCA-PUMP-BARREL.HOSE-3M	065352432-0000-10	126
ARCA-PUMP-BARREL.HOSE-5M	065352866-0000-10	126
ARCA-PUMP-BARREL.HOSE-10M	065353153-0000-10	126
ARCALUB-C1.CONNECT-G1/4	095291598-0000-10	126

<b>Manual lubrication tools</b>		
Ordering designation	Ordering number	Page
<b>Arcanol hobbocks</b>		
ARCANOL-FOOD2-25KG#K	019143630-0000-10	127
ARCANOL-LOAD220-25KG#K	019143761-0000-10	127
ARCANOL-LOAD400-25KG#K	019143800-0000-11	127
ARCANOL-LOAD460-25KG#S	065827066-0000-10	127
ARCANOL-MOTION2-25KG#S	080267009-0000-10	127
ARCANOL-MULTI2-25KG#K	019143885-0000-10	127
ARCANOL-MULTITOP-25KG#K	019144008-0000-11	127
ARCANOL-TEMP120-25KG#K	019144105-0000-10	127
ARCANOL-LOAD150-50KG	059810025-0000-10	127
ARCANOL-LOAD400-50KG	019143826-0000-11	127
ARCANOL-LOAD460-50KG	065827120-0000-10	127
ARCANOL-MOTION2-50KG	080267157-0000-10	127
ARCANOL-TEMP110-50KG	038705478-0000-10	127
<b>Grease pistols and accessories</b>		
ARCA-PUMP-BARREL.GUN-METER	065353269-0000-10	130
ARCA-PUMP-BARREL.GUN-H	065353617-0000-10	130
ARCA-PUMP-BARREL.GUN-P	065353323-0000-10	130
ARCA-PUMP-BARREL-S.GUN-HOSE	077464478-0000-10	131
ARCA-PUMP-BARREL-S.GUN-PIPE	077464648-0000-10	131
ARCA-PUMP-BARREL-S.FIT-4-JAWS	077465130-0000-10	131
ARCA-PUMP-BARREL-S.FIT-HEX16	0775904650000-10	131
ARCA-PUMP-BARREL-S.FIT-HEX16P	077590600-0000-10	131
<b>Transport aids</b>		
ARCA-PUMP-BARREL-S.HANDLE	065353803-0000-10	132
ARCA-PUMP-BARREL-25-S.TROLLEY	077464036-0000-10	132
ARCA-PUMP-BARREL-50-S.TROLLEY	074444239-0000-10	132



# Customer-specific lubrication gears and chain lubrication pinions

## Data required for design

Gear, toothed rack

Modulus M \_\_\_\_\_

Number of teeth (gear only) \_\_\_\_\_

Tooth set width \_\_\_\_\_ mm

Tooth set angle \_\_\_\_\_ °

left hand = “-”, straight teeth = “”, right hand = “+”

## Chain

Type \_\_\_\_\_

simplex     duplex     triplex

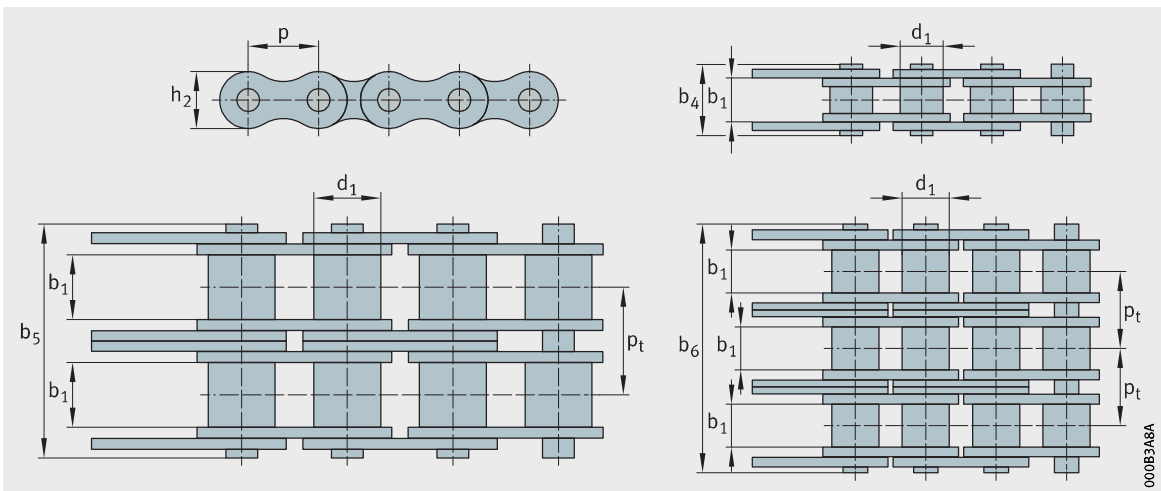

In the case of chains that do not correspond to ISO 606 (DIN 8188, DIN 8187), the additional following data are required:

Roller width  $b_1$  \_\_\_\_\_ mm

Pin length  $b_4, b_5, b_6$  \_\_\_\_\_ mm

Roller diameter  $d_1$  \_\_\_\_\_ mm

Link height  $h_2$  \_\_\_\_\_ mm

Pitch  $p$  \_\_\_\_\_ mm

Transverse pitch  $p_t$  \_\_\_\_\_ mm

# Customer-specific lubrication gears and chain lubrication pinions

## Lubricant

Type \_\_\_\_\_

Grease       Oil

The following documents relating to the lubricant have been added to this checklist (necessary for enquiry):

Technical datasheet       Safety datasheet

## Available design envelope (L×W×H)

\_\_\_\_\_ × \_\_\_\_\_ × \_\_\_\_\_ mm

## Speed

Circumferential speed (gear) \_\_\_\_\_ m/s

Linear speed (toothed rack, chain) \_\_\_\_\_ m/s

## Operating temperature

from \_\_\_\_\_ to \_\_\_\_\_ °C

## Ambient conditions

Contamination       Water       Food industry       Outdoor use

## Relubrication

Lubrication device (designation) \_\_\_\_\_

Lubrication demand \_\_\_\_\_ g

every \_\_\_\_\_ hours

## Other information

---

---

---

---



**Schaeffler Technologies AG & Co. KG**

Georg-Schäfer-Straße 30

97421 Schweinfurt

Germany

[www.schaeffler.de/en/services](http://www.schaeffler.de/en/services)

Sales:

Phone +49 9721 91-0

Technical support:

[www.schaeffler.de/en/technical-support](http://www.schaeffler.de/en/technical-support)

All information has been carefully compiled and checked by us, but we cannot guarantee complete accuracy. We reserve the right to make corrections. Therefore, please always check whether more up-to-date or amended information is available. This publication supersedes all deviating information from older publications. Printing, including excerpts, is only permitted with our approval.  
© Schaeffler Technologies AG & Co. KG  
TPI 252 / 02 / en-GB / DE / 2021-10